

## ST-MB1596 OF

### Matte Black Topmount Workstation Sink

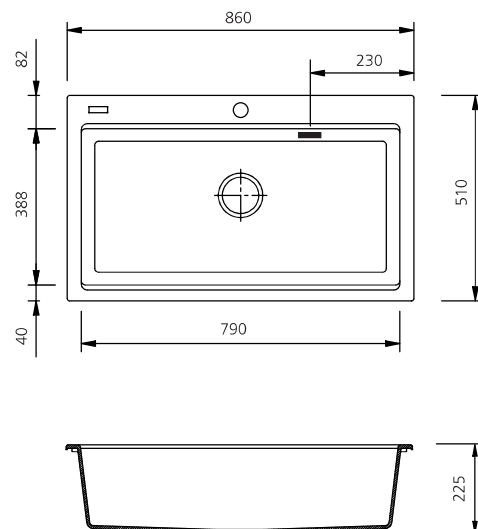

— Overflow location

## Specifications /

<b>Sink size</b>	860 W x 510 H mm
<b>Bowl size</b>	Workstation Bowl 790 W x 388 H x 225 D / 68 L
<b>Construction</b>	Moulded granite
<b>Material</b>	80% granite and quartz particles and 20% acrylic
<b>Installation</b>	Topmount
<b>Fixings</b>	Supplied
<b>Reversible</b>	No
<b>Min cabinet size</b>	900 mm
<b>Tap holes</b>	One tap hole only
<b>Waste fittings</b>	1 x 90 mm basket waste included
<b>Overflow</b>	Overflow kit included
<b>Carton size</b>	960 x 590 x 310 mm
<b>Weight</b>	22 kg
<b>Warranty</b>	Lifetime manufacturer's warranty (refer to Oliveri website)
<b>Maintenance and care instructions</b>	Clean the sink regularly with warm water, a liquid detergent and a soft cloth. Do not use abrasive powders or creams and avoid chemically aggressive detergents. Generic stains should be removed immediately with very hot water and a cleaning product. For organic stains which are especially difficult to remove, it is recommended that you fill the sink with a highly diluted organic cleaner such as bleach and let stand overnight. The next morning, rinse with warm water and a soft cloth.

## Included accessories /

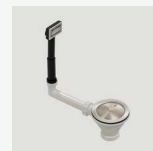

**AC10**  
Basket Waste with  
Rectangular Overflow



**ACWSC1596BK**  
Black Workstation  
Plastic Colander



**ACWSB1596BK**  
Black Workstation  
Preparation Board

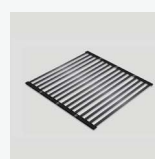

**ACWSRM1596BK**  
Black Workstation  
Roller Mat